



## FUNCTION ROOMS

	Length (m/ft)	Width (m/ft)	Net Floor area (sq.m/sq.ft)	Ceiling height(m/ft)	Doorway height(m/ft)	Set dinner	Dinner dance stage	Buffet	Buffet dinner dance	Chinese dinner	Cocktail	Boardroom style	Classroom style	Theatre style	U-shape	Floor loading (kg/sq.m/lb/sq.ft)
<b>Harbour View Room</b>	33 / 109	11 / 36	356 / 3831	3 / 10	2 / 7	320	250	260	230	384	450	-	180	350	-	490 / 100
Harbour View Room I	9 / 28	14 / 47	122 / 1313	3 / 10	2 / 7	80	60	70	60	96	90	-	60	120	36	490 / 100
Harbour View Room II	8 / 26	10 / 34	82 / 882	3 / 10	2 / 7	60	30	60	Subject to requirement	72	80	-	40	60	25	490 / 100
Harbour View Room III	8 / 26	10 / 33	80 / 861	3 / 10	2 / 7	60	30	60	Subject to requirement	72	80	-	40	60	25	490 / 100
Harbour View Room IV	9 / 28	9 / 28	72 / 775	3 / 10	2 / 7	50	30	48	Subject to requirement	60	60	-	40	60	21	490 / 100
Harbour View Room I + II	17 / 55	12 / 41	204 / 2195	3 / 10	2 / 7	150	120	130	100	180	200	-	100	200	40	490 / 100
Harbour View Room III + IV	17 / 55	9 / 30	152 / 1636	3 / 10	2 / 7	110	90	90	70	132	150	-	60	120	30	490 / 100
<b>Gloucester Room</b>	32 / 106	11 / 35	336 / 3615	2.7 / 9	2 / 7	220	200	200	170	264	350	-	150	250	-	490 / 100
Gloucester Room I	16 / 53	11 / 36	176 / 1894	2.7 / 9	2 / 7	120	100	100	80	144	150	-	60	100	30	490 / 100
Gloucester Room II	16 / 53	10 / 33	160 / 1722	2.7 / 9	2 / 7	90	80	90	70	108	100	-	70	160	40	490 / 100
Kellett Room I	10 / 32	6 / 19	96 / 603	3 / 10	2 / 7	30	-	-	-	36	30	16	24	40	18	490 / 100
Kellett Room II	10 / 32	7 / 22	62 / 667	3 / 10	2 / 7	30	-	-	-	36	30	16	24	40	22	490 / 100
Kellett Room III	10 / 32	7 / 22	62 / 667	3 / 10	2 / 7	30	-	-	-	36	40	16	24	40	22	490 / 100
Kellett Room IV	9 / 31	6 / 21	58 / 624	3 / 10	2 / 7	30	-	-	-	36	40	16	24	40	22	490 / 100
<b>Marina Room</b>	28 / 91	13 / 43	360 / 3874	3 / 10	2 / 7	310	250	240	210	360	450	-	180	350	-	490 / 100
Marina Room I	15 / 50	15 / 49	220 / 2367	3 / 10	2 / 7	150	120	130	100	180	200	-	100	200	40	490 / 100
Marina Room II	13 / 42	11 / 36	140 / 1505	3 / 10	2 / 7	90	70	80	50	108	150	-	50	100	25	490 / 100



## BUSINESS CENTRE CONFERENCE ROOMS

	Length (m/ft)	Width (m/ft)	Net floor area (sq.m/sq.ft)	Ceiling height (m/ft)	Boardroom style	Round table
Business Centre Conference Room I	4 / 14	7 / 23	29 / 312	3 / 9	10	-
Business Centre Conference Room II	5 / 16	4 / 12	17 / 183	3 / 9	-	6
Business Centre Conference Room III	8 / 27	5 / 16	39 / 420	3 / 9	16	-
Business Centre Conference Room IV	5 / 18	4 / 14	23 / 247	3 / 9	-	10

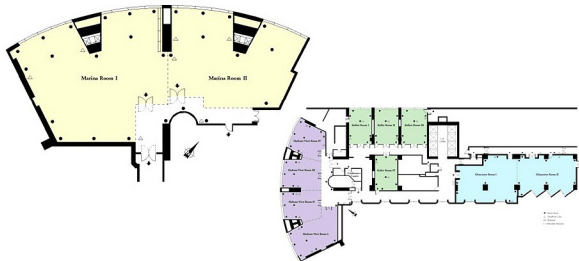

THE EXCELSIOR  
HONG KONG

The Excelsior, Hong Kong  
281 Gloucester Road, Causeway Bay, Hong Kong  
Telephone: (852) 2894 8888 Facsimile: (852) 2895 6459  
E-mail - General enquiry: [ethkg-info@rohkg.com](mailto:ethkg-info@rohkg.com) E-mail - Room reservations: [ethkg-reservations@rohkg.com](mailto:ethkg-reservations@rohkg.com)  
[www.excelsiorhongkong.com](http://www.excelsiorhongkong.com)