



## FACT SHEET

Mandarin Oriental's acclaimed collection of luxurious hotels and resorts are perfectly located in the world's most prestigious locations. Steeped in the traditional values of our oriental heritage, each hotel delights you with inspired, individual style, exquisite, sophisticated facilities and personal, passionate service.



Mandarin Oriental, New York redefines luxury as the City's most striking and sophisticated hotel. Contemporary in design, yet with stylish oriental flair, the hotel provides an unparalleled New York guest experience, with Mandarin Oriental's legendary reputation for award-winning service.





# FACT SHEET



## LOCATION

Conveniently situated at the union of Columbus Circle and Central Park, the hotel is located on floors 35 through 54 of the Time Warner Center. Guests are greeted with breathtaking views of Central Park, the Hudson River and the Manhattan skyline and can enjoy instant access to the Center's luxury boutiques and acclaimed restaurants, as well as the performances of Jazz at Lincoln Center.



## GUEST ROOMS

Guests can choose Central Park or Hudson River views among multiple room layouts. All rooms offer three multi-line telephones with voice mail, high-definition LCD flat panel televisions, surround sound stereo including CD and DVD options, an extensive selection of video-on-demand movies, oversized marble baths with a separate, glass-enclosed shower, luxurious Fili D'oro linen, plush terry bathrobes and slippers and exclusive Aromatherapy Associates bath amenities.



Category	Number	Sq ft
Superior Rooms	40	425
Deluxe Rooms	26	410
Hudson River View Rooms	58	400
Central Park View Rooms	78	420



## SUITES

Guests can select from a variety of suite layouts strategically located in the corners of the hotel to maximize the dramatic floor-to-ceiling views of Central Park and the Hudson River, all the while enjoying attentive service and every additional luxury.



Category	Number	Sq ft
Mandarin Executive Suite	16	800
Central Park View Suite	14	800
Premier Central Park View Suite	16	820
The Tai-Pan Suite	1	1,250
The Oriental Suite	1	1,800
The Presidential Suite	1	2,230

## RESTAURANT, BAR AND LOUNGE

### Asiate

Asiate presents an artistic and modern approach to French and Japanese cuisine, served in an environment of simplicity, elegance, balance and vitality.

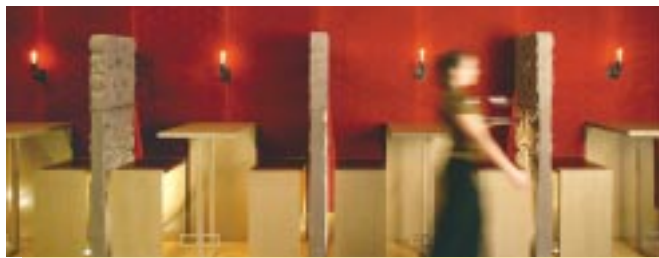

### MObar

A stylish cocktail bar in polished hammered nickel and tailored leather seating creates a lively atmosphere.

### Lobby Lounge

A dramatic panorama of Central Park and the city skyline is the perfect setting for light refreshments, afternoon tea and late night desserts.

## THE SPA AT MANDARIN ORIENTAL, NEW YORK



The 14,500 square-foot spa and fitness facility features eight treatment rooms including a VIP suite providing Asian inspired spa treatments. The Spa's unique elements also include vitality pools, amethyst crystal steam rooms, experience showers, an oriental style tea room, relaxation lounges, a high performance fitness center with multi-sensory exercise equipment and a naturally-lit 75-foot lap pool.

## AMENITIES

- 24-hour room service
- A multilingual Clefs d'Or concierge staff
- Business center



## Function Space

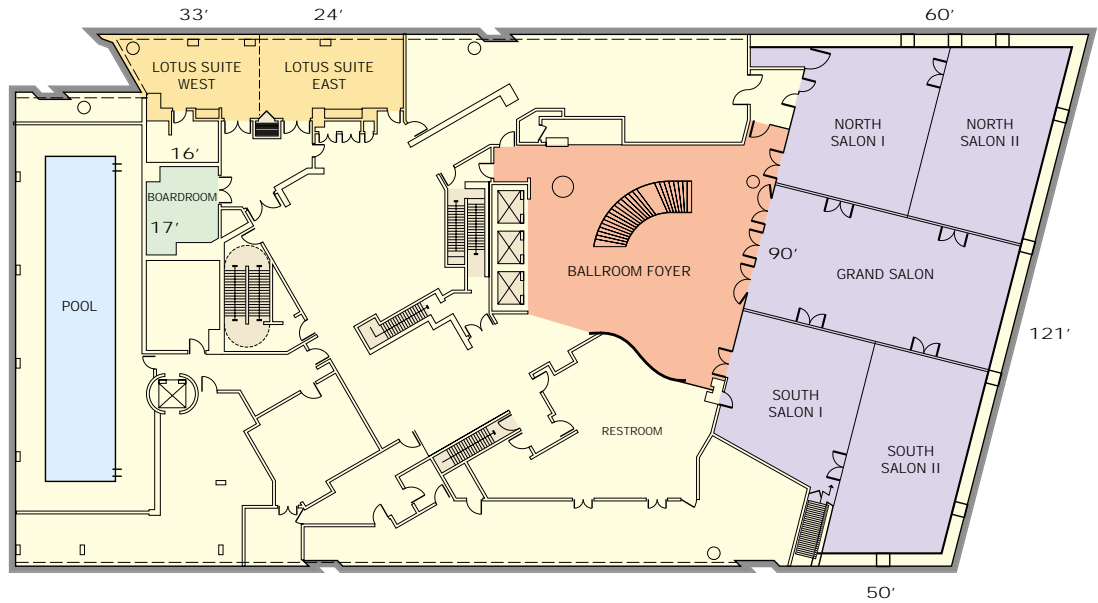

## Function / Meeting Space

Function Room	Dimensions Sq ft / Sq m	Ceiling Height	Banquet Rounds	Dinner & Dance	Reception	Theater Style	Classroom	Boardroom	Hollow
Mandarin Ballroom	6,000 / 540	16 ft	500	400	900	600	300	130	170
Ballroom Foyer	2,400 / 216	18 ft	–	–	400	–	–	–	–
Lotus Suite	960 / 89	11 ft	70	30	120	80	40	–	–
Boardroom	250 / 23	10 ft	–	–	–	–	–	8	–

### Hotel address:

80 Columbus Circle at 60th Street  
 New York, NY 10023, USA  
 Telephone +1 (212) 805 8800  
 Facsimile +1 (212) 805 8888



[www.mandarinoriental.com](http://www.mandarinoriental.com)