



FACT SHEET

Opened in 2005, and fabulously located within the heart of the prestigious financial district, Mandarin Oriental, Tokyo brings contemporary luxury to Nihonbashi, the historical and cultural centre of Tokyo commerce.

Overlooking the Imperial Palace Garden to the west and Tokyo Bay to the east, the hotel's award-winning spacious guestrooms, trendsetting Michelin-starred restaurants and exclusive spa are situated within the top floors of the soaring Nihonbashi Mitsui Tower, while its business centre and stately banquet and

conference facilities reside within the adjacent Mitsui Main Building, a cultural heritage property.

The dynamic multi-purpose complex blends the best of new and old architecture and has direct access to the city's subway stations, and is just minutes walking distance from Mitsukoshi's main department store, the Tokyo Stock Exchange, Bank of Japan, Tokyo Station, Imperial Palace and exclusive Ginza shopping area.





FACT SHEET

LOCATION

A few minutes walk from Mandarin Oriental, Tokyo is the celebrated "Bridge of Japan" from which Nihonbashi takes its name. Next to the bridge is the traditional zero-mile marker from where the cities infrastructure was initiated. Japan's major financial, insurance and securities firms grew around this landmark along with many centuries-old Japanese shops. Guests arriving at Mandarin Oriental, Tokyo will be ushered through a private entrance and via spacious high-tech elevators, directly to the 38th floor Sky Lobby, where a breathtaking view of the dramatic cityscape and sky above is revealed through oversized glass windows.

GUESTROOMS AND SUITES



The 179 luxurious appointed guestrooms and suites located from the 30th to 36th floors of the futuristic, 38-storey Nihonbashi Mitsui Tower provide spectacular views of the Tokyo metropolis through large guest room bay windows. The oversized guestrooms range from 50 to 60 square metres, while the opulent suites range from 90 to 250 square metres.

Room Types	Number	Area (m ² / ft ²)
Deluxe	34	50 / 538
Premier Deluxe	48	50 / 538
Mandarin Deluxe	25	50 / 538
Mandarin Corner	8	50 / 538
Premier Grand	42	60 / 646
Executive Suite	4	90 / 969
Mandarin Suite	10	100 / 1,076
Dynasty Suite	3	100 / 1,076
Oriental Suite	4	100 / 1,076
Presidential Suite	1	250 / 2,691

RESTAURANTS AND BARS



An exciting range of dining venues await hotel guests and domestic residents alike. Stunning views from the tower's two top floors can be enjoyed from the two bars, the lobby lounge and restaurants serving authentic Cantonese, modern French and Asian inspired Continental cuisines. On the second floor, a casual restaurant serves Italian fare while a premier cake shop greets all visitors at the hotel's street level entrance.

K'shiki, All Day Dining	● 38th floor
Oriental Lounge	● 38th floor
Tapas Molecular Bar - Michelin One Star	● 38th floor
Signature, French Inspired Dining - Michelin One Star	● 37th floor
Sense, Cantonese Dining - Michelin One Star	● 37th floor
Sense Tea Corner	● 37th floor
Mandarin Bar	● 37th floor
Ventaglio, Italian Dining	● 2nd floor
Mandarin Oriental Gourmet Shop	● Ground floor

THE SPA AT MANDARIN ORIENTAL



The Spa at Mandarin Oriental, Tokyo merges therapies and philosophies from around the world into an exotic blend of treatments. In nine serene rooms, including five suites, guests will be guided

through a personalised journey of Asian and western-inspired relaxation, beauty and wellness components that aim to bring an exceptional awareness of true well-being.



FLOOR GUIDE

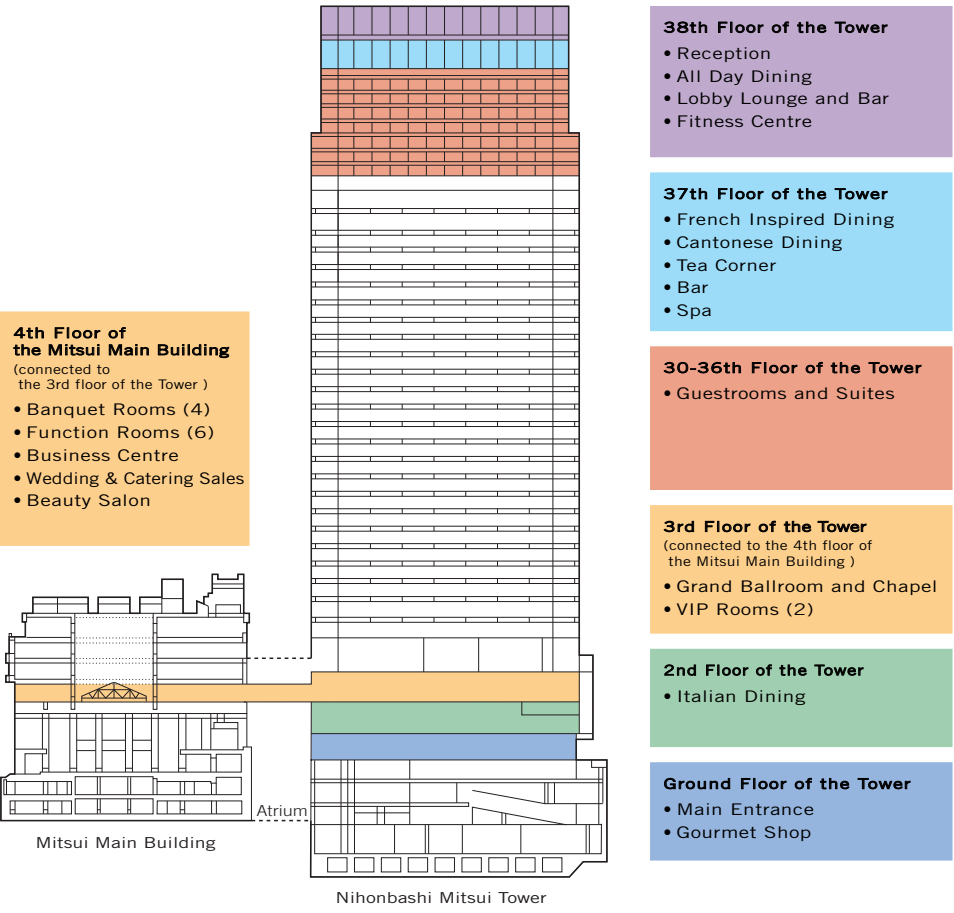

TRANSPORTATION

- Narita International Airport approx. 70 minutes by car
- Haneda Airport approx. 40 minutes by car
- Tokyo City Air Terminal approx. 10 minutes by car
- Tokyo Station 8 minutes on foot
- Mitsukoshimae Station direct access
(Tokyo Metro Ginza Line and Hanzomon Line)



MANDARIN ORIENTAL, TOKYO
 2-1-1 Nihonbashi Muromachi Chuo-ku, Tokyo 103-8328
 Telephone +81 (3) 3270 8800 Facsimile +81 (3) 3270 8828
www.mandarinoriental.com/tokyo

MEETING AND BANQUET VENUES

By uniting a modern multipurpose tower with a historical landmark, the hotel complex offers guests the unique privilege of utilizing spaces within a culture heritage property for special occasions. In addition a grand ballroom and wedding chapel is located on the third floor of the new tower. Further four large banquet halls, six meeting rooms and the hotel's business centre are located on the fourth floor of the historical Mitsui Main Building, which is directly connected to the tower and hotel facilities within it via a bridge.

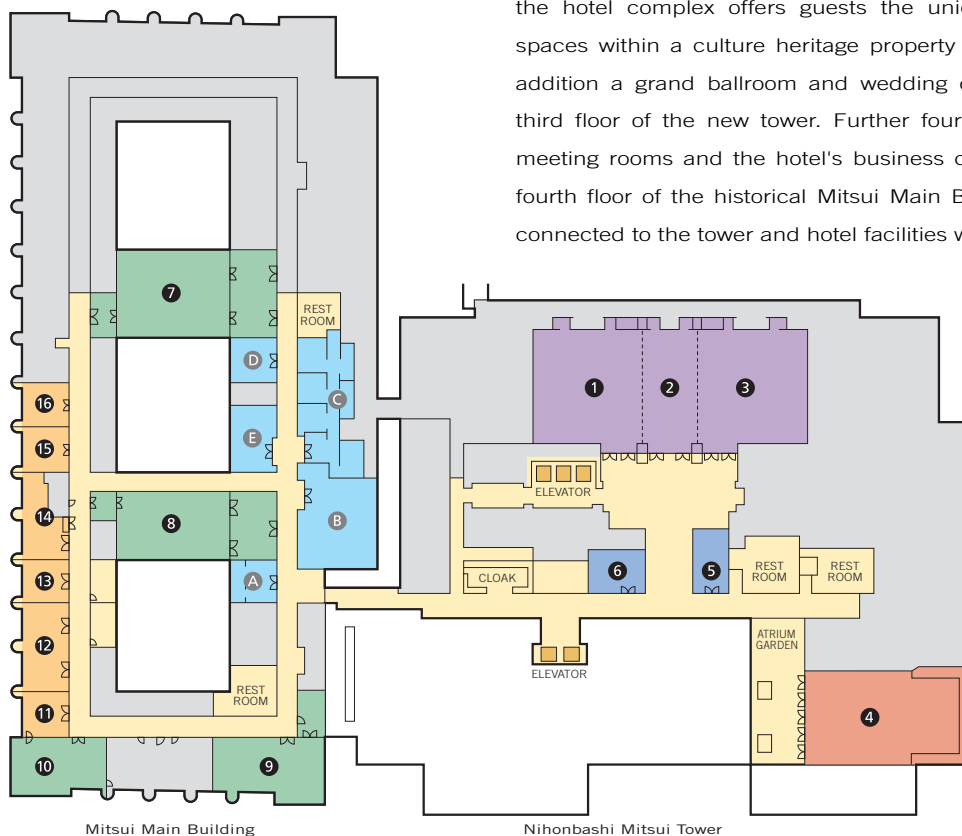

- A Business Centre
- B Wedding and Catering Sales
- C Beauty Salon
- D Florist
- E Wedding Costume Shop

Venue	Mitsui Main Bldg.	Tower	Area(m ² /ft ²)	Cocktail	Dinner	Classroom	Theatre
1 2 3 Grand Ballroom		○	550 / 5,920	400	320	260	500
1 2 / 2 3 Grand Ballroom		○	315 / 3,391	250	180	180	300
1 / 3 Grand Ballroom		○	210 / 2,260	150	120	100	200
4 Sanctuary		○	250 / 2,691	120	—	80	150
5 North Room		○	38 / 409	—	—	—	—
6 South Room		○	36 / 388	—	—	—	—
7 Linden Room	○		166 / 1,787	120	100	90	150
8 Alder Room	○		130 / 1,399	80	60	60	120
9 Oak Room	○		107 / 1,152	60	50	40	80
10 Maple Room	○		81 / 872	—	20	—	—
11 Akane	○		35 / 377	—	8	—	20
12 Beni	○		70 / 754	40	20	30	40
13 kouji	○		35 / 377	—	8	—	20
14 Toki	○		35 / 377	—	10	—	—
15 Ruri	○		35 / 377	—	8	—	20
16 Shion	○		35 / 377	—	8	—	20

